

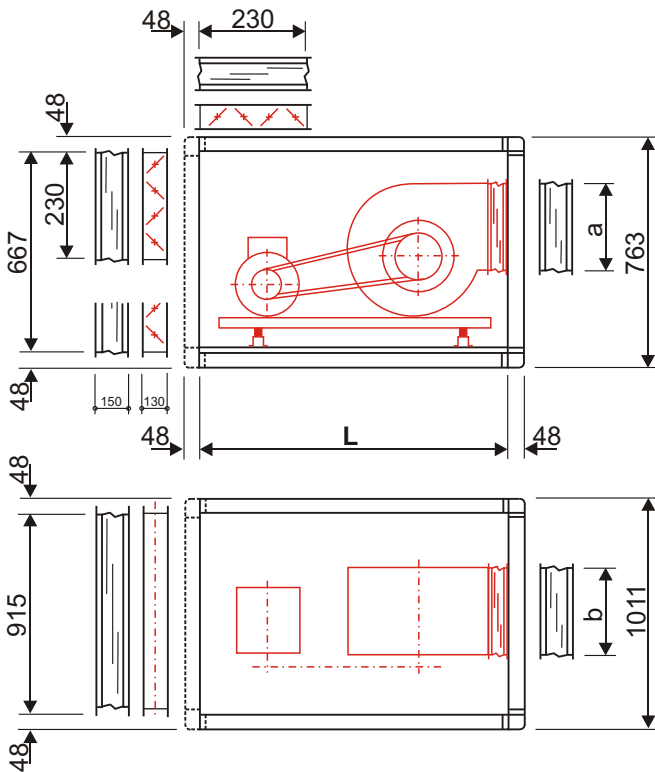

V Ventilatorteil

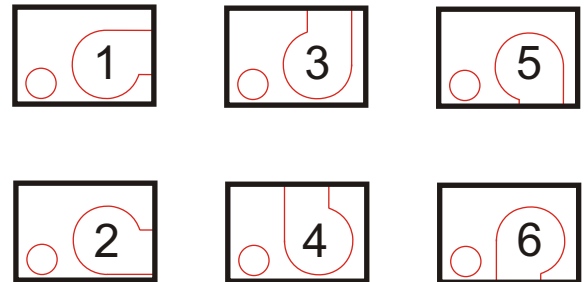

Ausblasstellungen



Vent.-type	Ausblasst.	Motorgröße		a/b
		71-112	132	
		Ventilatorgehäuselänge L		
225	1-6	915		290
250	1-6	915	1220	322
280	1-6	915	1220	361

A Ansaugteil

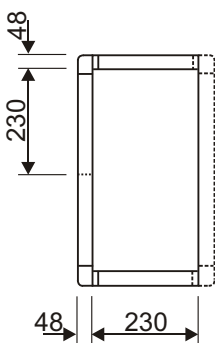

M Mischteil

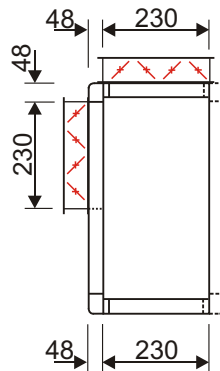

M2 Doppelmischteil

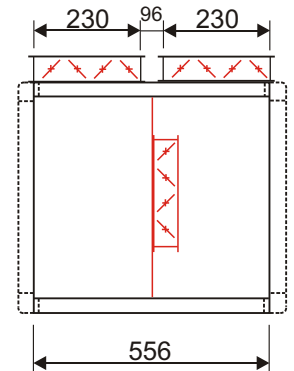

Klappen der Ansaug- und Mischteile auf Wunsch mit den Massen 340 oder 455 an Stelle von 230 mm (Achtung ! Bauteillängen entsprechend anpassen).

L Leerteil

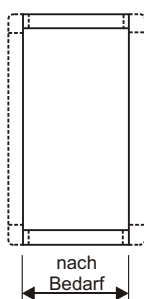

LB Leerteil mit Bedientür

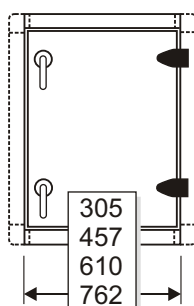

P Prallplatten-diffusor

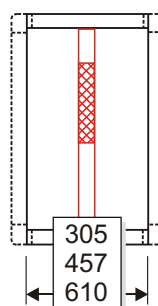

SD Schalldämpfer

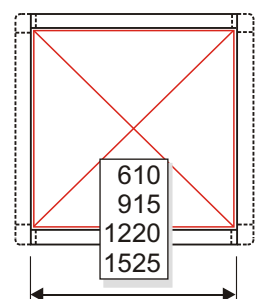



KF Kassetten-
filterteil

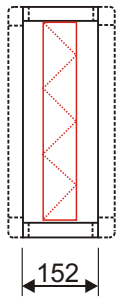

TF Taschen-
filterteil

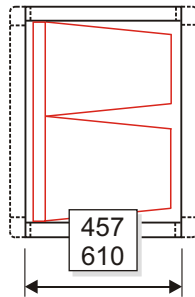

AF Absolut-
filterteil

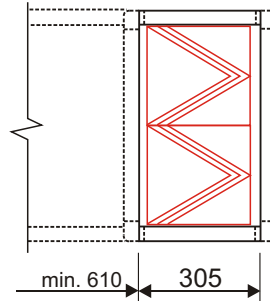

AKF Aktivkohle-
filterteil

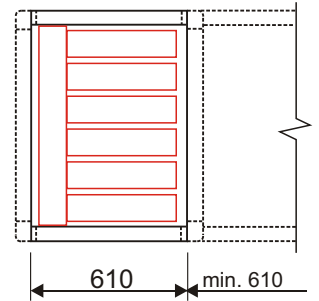

EH Erhitzer-
teil

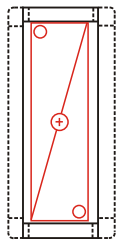

152 1-3 RR
305 4-6 RR

KH Kühltenteil

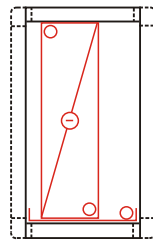

305 4-6 RR
457 7-8 RR

KHT Kühltenteil
mit TA

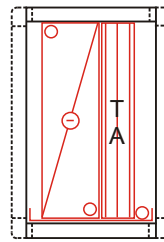

457 4-6 RR
610 7-8 RR

TA Tropfen-
abscheider

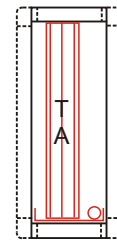

152

FS Frost-
schutz

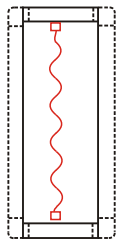

152

EE El.-
Erhitzer

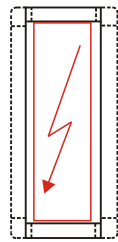

305

DB Dampf-
befeuchter

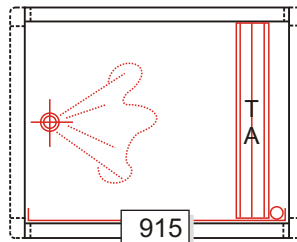

915
1220
1525

OB Oberflächen-
befeuchter

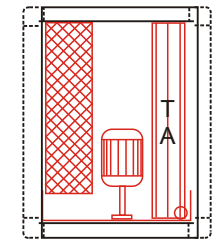

610

Maßliche Änderungen vorbehalten. Die angegebenen Abmessungen sind Vorschläge und nicht bindend.
Die flexible WEGER Fertigung erlaubt Gerätefertigung "nach Maß"